

# A guide to Hypothes.is at UCT

<http://bit.ly/HypothesisGuide>



Centre for  
Innovation in  
Learning and  
Teaching

1.	What is Hypothes.is?	1
2.	How do I get started?	1
3.	Features	1
4.	Tracking and reporting	2
5.	Use cases / Examples of Classroom Use	2
6.	General Considerations	3
7.	Setup: Add Hypothes.is to Amathuba Content	3
8.	Setup: Add Hypothes.is to Vula Lessons	5
9.	Create a Hypothes.is Group Assignment	6
10.	General How To	8
11.	Additional Resources	8
12.	Further links	9
12.1.	Support	9
12.2.	General	9



This work has been licensed under a [Creative Commons Attribution 4.0 International License \(CC BY\)](https://creativecommons.org/licenses/by/4.0/)

# 1. What is Hypothes.is?

Hypothes.is is a tool that provides the ability to annotate or make page notes on any publicly accessible PDF document or Web page and integrates easily with Vula and Amathuba. Students can elect to keep their annotations private or make them visible to the whole site where other students can add their own comments as a reply. In addition, students can use the highlight feature, which is visible only to themselves and is a useful study aid. Lecturers can view all contributions or choose to filter by student name and then apply a grade that feeds into the Vula Gradebook.



# 2. How do I get started?

Hypothes.is is integrated with Vula and can identify student contributions aligned to their student profile in Vula. There is no sign-up procedure required for students or lecturers to use Hypothes.is in Vula. [Find out how to add Hypothes.is to your Vula site.](#)

# 3. Features

- Hypothes.is can be used to provide [annotations, highlights and page notes](#) on any publicly accessible PDF file or web page.
- Users' page notes and annotations can be kept private (to the user only) or shared within the Vula site.
- Vula groups can be used to create smaller interactions using Hypothes.is. If you will be using the same resource with multiple groups, ensure that each resource has a [unique fingerprint](#).
- Other students in the Vula site can reply to shared page notes and annotations.
- The **Highlight** feature, which is always only privately visible, provides a way for each individual student to highlight the text.
- Tags can be applied to contributions, which assists with finding contributions quickly through filtered searches.
- Users can include basic text formatting, links and images in annotations and page notes.
- Lecturers can grade student contributions. These grades feed into the Vula Gradebook.

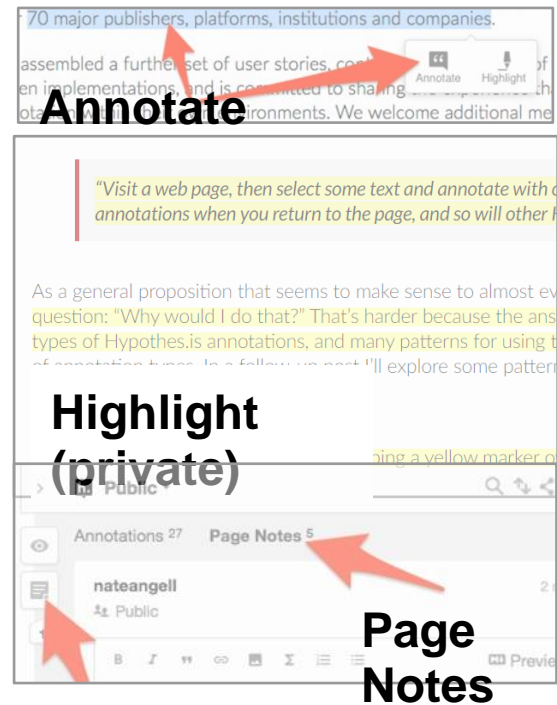

This work has been licensed under a [Creative Commons Attribution 4.0 International License \(CC BY\)](#)

*Adding an annotation in Hypothes.is*

## 4. Tracking and reporting

- Hypothes.is supports Vula Gradebook integration.
- Lecturers can see a filtered view of annotations by student or tag.
- Annotations and limited high-level information (such as total number of annotations) can be exported (on request).

## 5. Use cases / Examples of Classroom Use

- <https://web.hypothes.is/case-studies/>
- <https://web.hypothes.is/education/examples-of-classroom-use/>
- <https://web.hypothes.is/education/exemplars/highereducation/>

Here are some resources to help you get started with Hypothes.is:

- See what [teachers](#) and [students](#) say about the power of collaborative annotation
- [10 Ways to Annotate with Students](#)
- [Annotation Tips for Students](#)

For model assignments, product tutorials, teacher testimonials, and much more, visit the Hypothes.is [Educator Resource Guide](#). Direct your students to the [Student Resource Guide](#) for student-centred materials from tips for best annotation practices to inspirational poetry about marginalia.



This work has been licensed under a [Creative Commons Attribution 4.0 International License \(CC BY\)](#)

## 6. General Considerations

- Hypothes.is is not a data-free tool, even when it is used within Vula. Hypothes.is' text-based annotations use a minimal amount of data; the size of the PDF file or Web page being annotated also contributes to the total data usage.
- PDF documents need to be publicly accessible and [OCR-optimised](#) for annotations and highlights to be applied to the document. (Optical Character Recognition is a process in which software converts images of text into a machine-readable format.)
- If using multiple copies of a similar resource, for example, with group work, each PDF document needs to have a **unique fingerprint**. Learn more about [using PDF fingerprints to create Hypothes.is reading groups](#).
- Grades assigned are given out of 10 within the Hypothes.is interface but are represented in the Vula Gradebook as being out of 100.  
(Example: A grade of 5.2 in Hypothes.is will be represented as 52 in the Vula Gradebook)
- Grades are assigned per student on any one Hypothes.is resource, not per annotation.
- Hypothes.is can be added to a Lessons Page (multiple times) by Vula site members in the Support Staff and Site Owner roles.
- Hypothes.is does not provide alerts when annotations are added, so lecturers would need to check back regularly for new contributions.

## 7. Setup: Add Hypothes.is to Amathuba Content

1. In the Content tool, click **Add Existing**. Then select **External Tool Activity**.



This work has been licensed under a [Creative Commons Attribution 4.0 International License \(CC BY\)](#)

## What would you like to add?

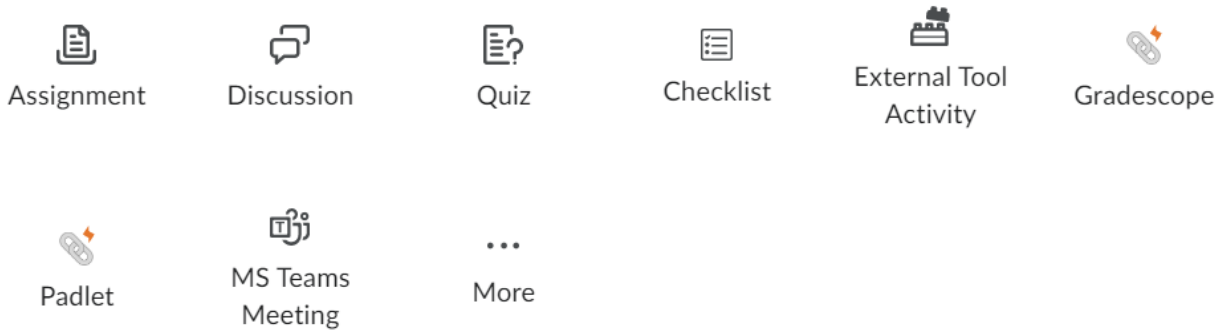

2. Select **Hypothesis**. This adds the Hypothes.is tool to your Amathuba site. The Content tool will reload with the message: “*Open link in a new web browser tab*”. If you would like to embed Hypothes.is on the Content page and/or add grading, click on the three dots and select **Edit**.

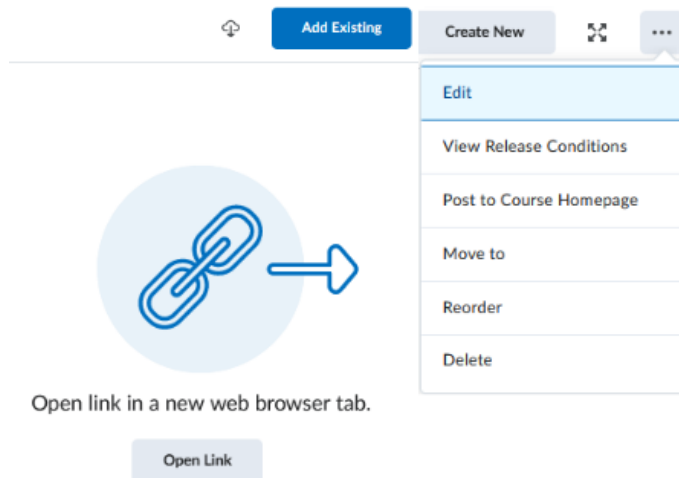

- **Embed on the page:** On the **Edit** page, under **Display Options**, select **Embed on the page**. Under **Assignment Details**, enter the URL of the web page of your PDF, click **Continue > Save and Close**.
- **Add Grading:** On the **Edit** page, under **Grade Items**, click on **Add and Manage Grade Items**. In the pop-up window, click on **+ Grade Item**, enter the required points the item should be graded out of in the Grades (Gradebook) tool > click **OK > Save and Close**. By default, the Grade Item will be given the same title as your Hypothes.is content item.



This work has been licensed under a [Creative Commons Attribution 4.0 International License \(CC BY\)](https://creativecommons.org/licenses/by/4.0/)

3. Upon clicking **Save and Close**, the Content tool will reload, displaying your reading resource in the Hypothes.is interface, with the addition of the optional Grading bar above the resource, if enabled.
4. When adding subsequent items, the tool will add the same one as before, unless you create a new LTI link. To do so, in the Content tool, click **Add Existing**, then select **External Tool Activity**. Scroll down and click **Create New LTI Link**. Ensure that you name the tool something different to the last item and enter the following URL: [https://lms.hypothes.is/lti\\_launches](https://lms.hypothes.is/lti_launches).
5. Click **Create and Insert**.
6. Continue as above.

**Note:** The Hypothes.is interface will always provide grading out of 10, while the equivalent point value you selected for the Grade Item will be added to Grades (Gradebook). Decimal places are supported in the Hypothes.is grading interface.

## 8. Setup: Add Hypothes.is to Vula Lessons

On the Vula Lessons page where you want to embed the Hypothes.is document:

1. **Lessons > Add Content > Add Learning App**
2. On the **Add Learning App** page, select **Hypothes.is**.
3. In the **Configure External Tool** window, enter a **Tool Title** (for your document) > **Save**.

There are 3 different ways you can go to the Hypothes.is document (you can this can be changed clicking on **Edit Item**):

- **New window** (opens in a new window)
- **New page** (opens in a separate Lessons page)
- **In line** (embedded on the Lessons page). If you choose the **In line** method, we recommend changing the **Height** field value (Example: 1500) and then updating the item.

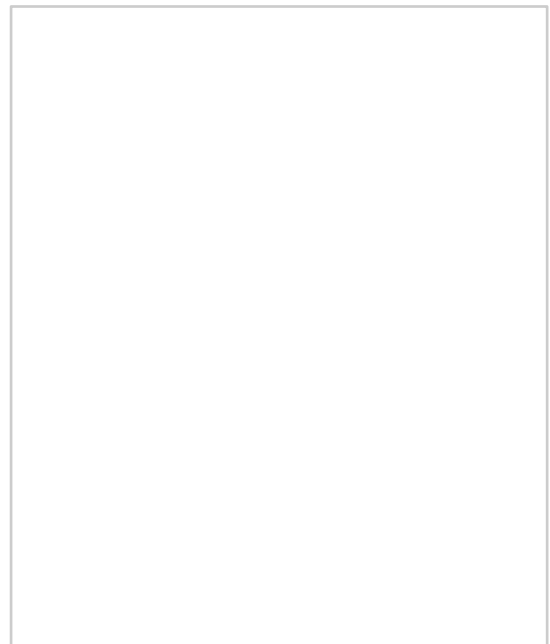

This work has been licensed under a [Creative Commons Attribution 4.0 International License \(CC BY\)](https://creativecommons.org/licenses/by/4.0/)

If you are not using in-line embed, click the new page/window link to open Hypothes.is in Vula.

#### 4. Click Save (do not enter URL in first window).

5. Click on the article you added. A new window will pop up and you can select to either:

- Enter URL of web page or PDF or
- Select PDF from Google Drive or
- Select PDF from OneDrive

**Note:** When selecting a PDF from Vula Resources, you will have to make the **PDF file publicly accessible** by locating it in **Resources**, clicking **Actions > Edit details** in line with the selected resource, and then selecting **This file is publicly viewable** for Hypothes.is to be able to access the file. Also ensure that the PDF file is [OCR optimised](#).

6. The web page/PDF will be displayed on your Lesson page and is ready for the class.

It is also possible to add Hypothes.is directly to the left menu toolbar as an external tool (**Site Setup > Manage Tools > External Tools** (expand) > **Hypothes.is**), but only one instance/document of Hypothes.is can be added to Vula using this method. If you will be annotating multiple resources at various times in the course, or using Hypothes.is for group work, follow the directions to add Hypothes.is to a Lessons page (see above).

## 9. Create a Hypothes.is Group Assignment

Please ensure that the groups on your Amathuba site have been created and populated before taking the following steps.

When creating a new Hypothes.is reading, you will be prompted to choose to configure the reading as a group assignment. Check the box next to **This is a group assignment** and select the group category to which you would like to assign the reading from the **Group set** dropdown list. (Note that the Group Set referred to in the Hypothesis app is the same as the Group Category in Amathuba).



This work has been licensed under a [Creative Commons Attribution 4.0 International License \(CC BY\)](#)

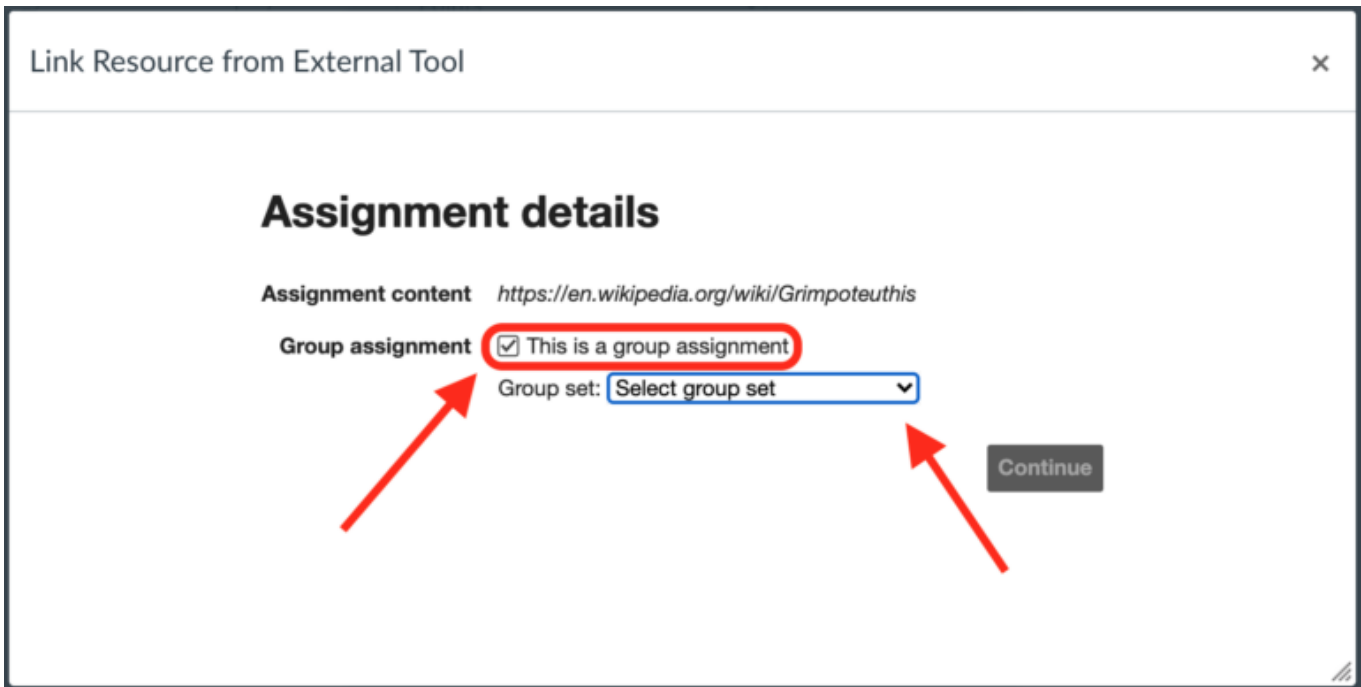

Users in the lecturer role can see all groups listed in the dropdown at the top of the Hypothes.is sidebar. To view annotations for a group, select the group name from the list.

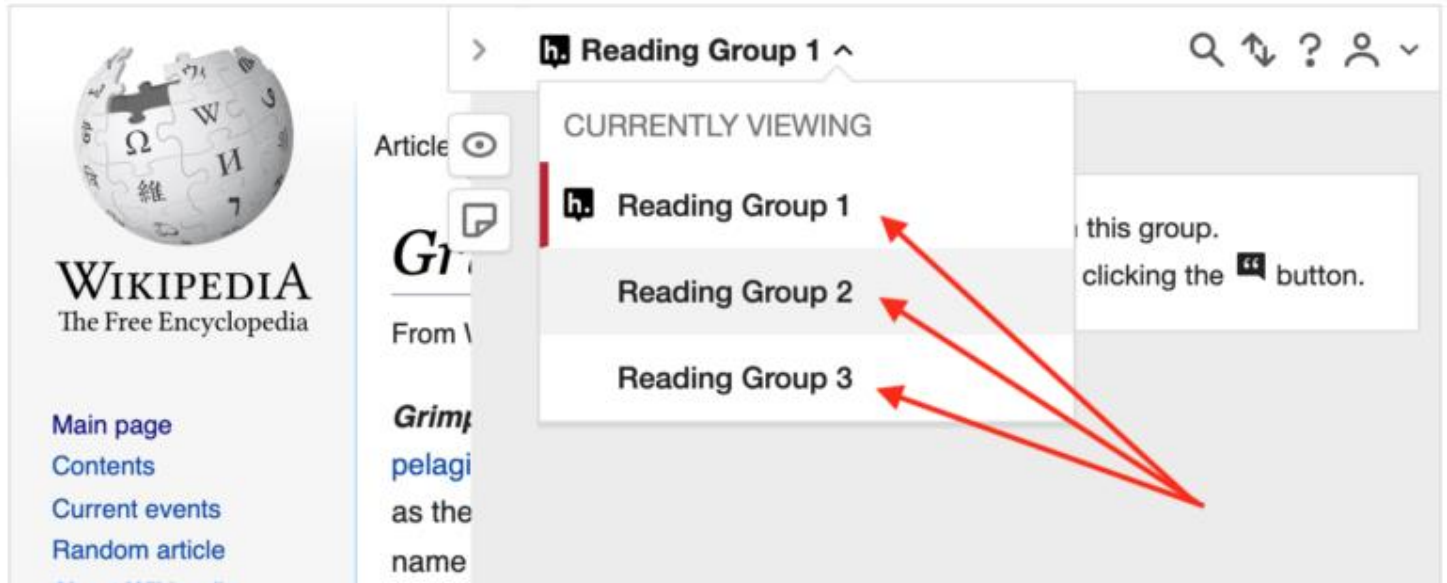

Students will only be able to see the group of which they are a member listed. Similarly, annotations that are posted by them will only be visible to members of their group.



This work has been licensed under a [Creative Commons Attribution 4.0 International License \(CC BY\)](https://creativecommons.org/licenses/by/4.0/)



## 10. General How To

- [Teacher Resource Guide](#)
- [Student Resource Guide](#)
- [CILT video - webinar recording](#)
- [Hypothesis Q&A Guide](#)

## 11. Additional Resources

- [OCRing a PDF](#)
- [Adding Links, Images, and Videos](#)
- [Using Tags Tutorial](#)
- Another useful site is [DocDrop](#) - a place to upload PDFs and other documents for annotation using Hypothesis, as well as a Google Drive plugin for PDFs.







This work has been licensed under a [Creative Commons Attribution 4.0 International License \(CC BY\)](#)

## 12. Further links

### Support

- [Hypothes.is Help articles](#)
- Request help: [support@hypothes.is](mailto:support@hypothes.is) or <https://web.hypothes.is/get-help>

### General

- Website: <https://web.hypothes.is>
- Social media:
  -  YouTube Channel: [www.youtube.com/user/hypths](http://www.youtube.com/user/hypths)
  -  Twitter /  X: [https://twitter.com/hypothes\\_is](https://twitter.com/hypothes_is)
  -  Facebook: [www.facebook.com/myhypothesis](http://www.facebook.com/myhypothesis)



This work has been licensed under a [Creative Commons Attribution 4.0 International License \(CC BY\)](https://creativecommons.org/licenses/by/4.0/)